

Location: \_\_\_\_\_



**P6290**

**12" Wide, Stainless Steel Frame and Grate System**

**SPECIFICATION:**

MIFAB® Series P6290, 12" wide, Load Class "A" Light duty slotted trench drain ADA compliant grate constructed of Type 304 stainless steel with 10 gauge stainless steel angle frame and anchor tabs. Free area of 23.00 square inches per 1' section. Also available with B, C, and D load rated stainless steel grates and optional anchor flange (Suffix -FL).

**FUNCTION:**

Used in laboratory, industrial, commercial, kitchen and other hygienic areas. Type 304 stainless steel construction provides for ease of cleaning, maintenance and sanitary installation. All grate openings are polished to a smooth finish.

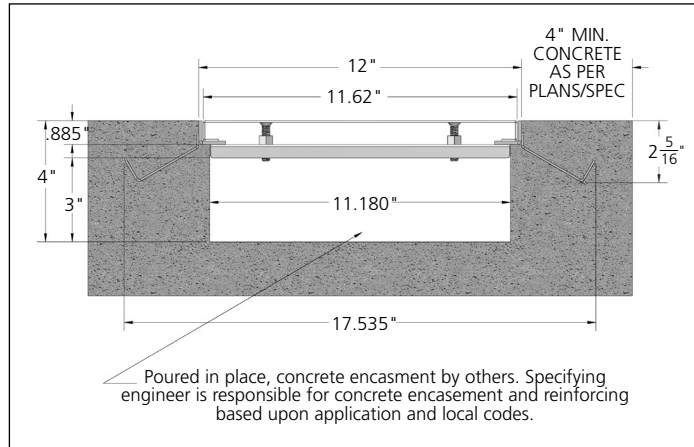

**Note:** Every order of this product is a special / custom order fabrication. This product is non returnable and noncancellable.



MODEL NUMBER	DESCRIPTION
<b>P6290</b>	12" wide, Type 304 Stainless Steel Frame and Grate System (Load Class "A", "Light Duty" ADA compliant grates)
<b>P6290-29</b>	12" wide, Type 316 Stainless Steel Frame and Grate System (Load Class "A", "Light Duty" ADA compliant grates)

OPTIONAL VARIATIONS	DESCRIPTION
<b>Length</b>	Specify the length that is required
<b>-LCB</b>	Load Class "B", Medium Duty Grate (2,000 - 4,999 lbs.)
<b>-LCC</b>	Load Class "C", Heavy Duty Grate (5,000 - 7,499 lbs.)
<b>-LCD</b>	Load Class "D", Extra Heavy Duty Grate (7,500 - 10,000 lbs.)
<b>-LS</b>	Longitudinal Slotted Grate (ADA Compliant)
<b>-NS</b>	Slip Resistant Grate (Non slip grit finish)
<b>-PG</b>	Perforated Grate (1/4" diameter holes)
<b>-PHP</b>	Perforated "Heel Proof Grate" (less than 1/4" diameter perforations)
<b>-SHP</b>	Slotted "Heel Proof" Grate (less than 1/4" wide slots)
<b>-5</b>	Sediment Bucket
<b>-6</b>	Vandal Resistant Grate
<b>-90</b>	90 Degree Section

CALIFORNIA PROPOSITION 65 WARNING. This product contains chemicals known to the State of California to cause cancer and birth defects or other reproductive harm.

Job Name: \_\_\_\_\_ Page No: \_\_\_\_\_  
 Section No: \_\_\_\_\_ Contract: \_\_\_\_\_  
 Schedule No: \_\_\_\_\_ Purchase Order No: \_\_\_\_\_