



CV

Bronze Silent Check Valve Threaded and Sweat Connections.

Function: The Beeco® Silent Check Valve is designed to reduce water hammer while performing all the same requirements of a swing check valve. The Sweat Version is designed to solder into lines without disassembly, a low temperature solder should be used in order to eliminate damage to the seating surface.

Ratings: Maximum Working Pressure 400 psi (27.6 bars); Temperature Rating -20° to 100° F (-29° C to 38° C). Maximum temperature rating is 400° F.

Materials: Body is made on C87800 no lead Bronze; Adapter and the Check are made from low lead C6802 Brass; Spring, Spring Guide and Stem are all made from a 300 series Stainless Steel and the Seat is a high temperature Viton material.

Features: Due to it's poppet design the Beeco Silent Check Valve can be installed in either the horizontal or vertical position. It's silent operation and low pressure drop make it superior to most swing check valves.

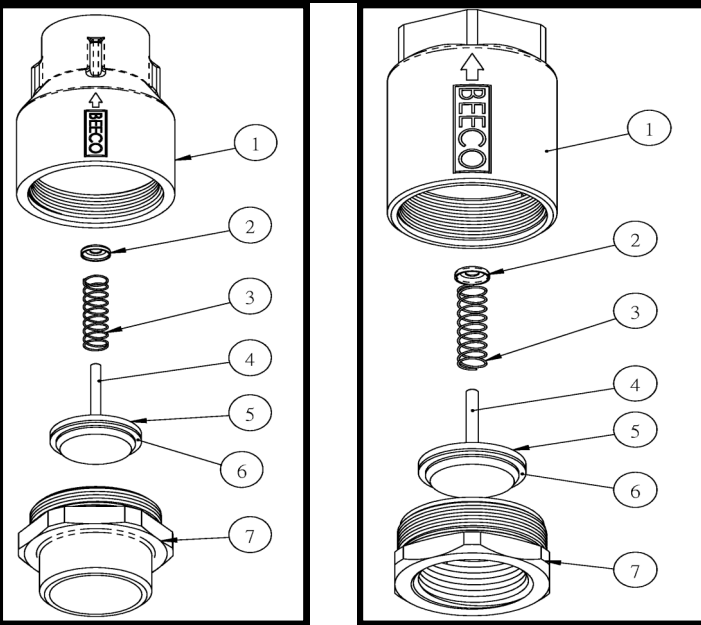

NO.	PART DESCRIPTION	MATERIAL	QTY
1	Body	Bronze(C87800)	1
2	Spring Guide	Stainless Steel(SS304)	1
3	Spring	Stainless Steel(SS304)	1
4	Stem	Stainless Steel(SS303)	1
5	Check	Brass(C6802)	1
6	Disc	Viton	1
7	Adapter	Brass(C6802)	1

Job Name: _____
 Section No: _____
 Schedule No: _____

Page No: _____
 Contractor: _____
 Purchase Order No: _____

Please consult BEECO engineering to get the latest updates On materials and specifications.

www.beecobackflow.com 1321 West 119th Street, Chicago IL, 60643
 BEECO Canada 150 Norfich Drive Unit 4, Toronto, Ontario, Canada
 M3N 1X6. Tel (416) 679-0380 Toll Free 1-800-387-3880